



JPTH-35 Pan-Tilt Head

***PRECISION MACHINED AND DESIGNED
FOR RUGGED ENVIRONMENTS***



JPTH-35 Pan-Tilt Head

BUILT RUGGED TO SURVIVE OUTDOORS

The JPTH-35 Pan-Tilt Head is an extremely rugged, heavy duty, highly engineered product which utilizes carefully selected components for reliable, maintenance free operation in all types of environments.

This unit features precision machining throughout with environmental protection to IP 68. The entire system is built to operate and survive in harsh environments with an operating temperature of -20C to +60C.

The pan-tilt head is well proven with hundreds in use worldwide. The unit is available in a 12VDC or 24VDC version.

With externally adjustable pan and tilt mechanical limit stops, feedback potentiometers and regenerative braking, this pan-tilt head is extremely easy to control.

**SPECIAL ORDER ONLY
12VDC OR 24VDC HEAVY DUTY PAN-TILT HEAD
OVER THE TOP OR SIDE ARM DESIGN**

FEATURES

- Precision Machined Pan-Tilt Head (capable of moving up to 55 lbs in side mount and 35 over the top)
- Rugged Construction
- Externally Adjustable Mechanical Limit Stops
- Precision Feedback Potentiometers Built In
- Regenerative Braking
- Operating Voltage 12VDC or 24VDC
- IP68 Rated
- Operating Temperature -20C to +60C
- 1-Year Warranty
- Mating Connectors Supplied
- Features Bronze Bearings for Quiet Operation



[TECHNICAL SPECIFICATIONS]

Height:	SM = 7.2 in OVT = 7.9 in	Feedback:	Precision 5K Pot (1 Per Axis) Requires 5VDC Ref. Voltage
Width:	SM = 6.5 in OVT = 6.5 in	Connector:	Mating Connector Supplied
Depth:	5.1 in without connectors	Speed:	Pan = 12, 18, 24, 32 or 48 Deg/Sec Tilt = 12 or 18 Deg/Sec
Materials:	Machined Alu w/ Stainless Fasteners Anodized Alu Mounting Ring Bronze Bearings for Quiet Operation Ball Bearings on Major Axes	Capacity:	SM = 55 lbs OVT = 35 lbs
Mounting Plate:	4-Holes tapped 1/4-20 on 4" PCD plus 4-Holes 1/4" Dia on 4" PCD Side Arm - 8 holes on 4" PCD Side Arm Center - 4.9in from face	Rotation Limits:	Pan = SM & OVT 350 Deg, Tilt = SM +/- 180 OVT -90 +25 Deg
Weight:	SM or OVT = <13 Lbs	Color:	Goose Grey
Voltage:	12VDC or 24VDC	Backlash:	< 0.15 Deg
Braking:	Regenerative	Maintenance:	None Required
		Operating Temp:	-20C to +60C
		Weatherproof:	IP68
		Warranty	1-Year

SM = Side Arm Mount

OVT = Over The Top
(not displayed)

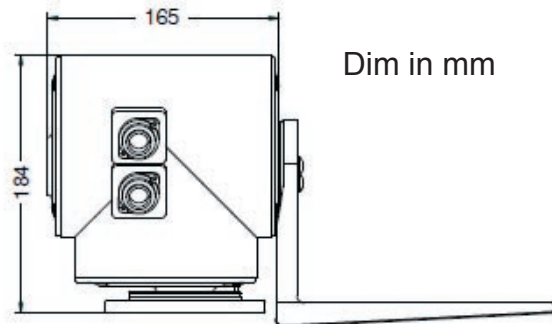
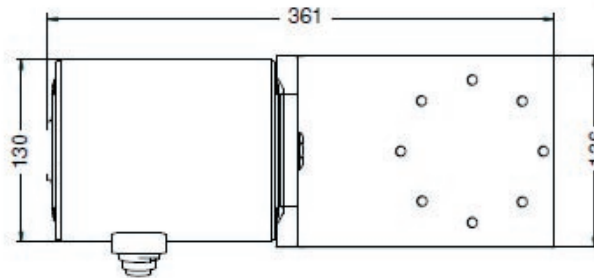

Dim in mm

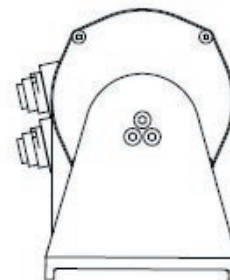
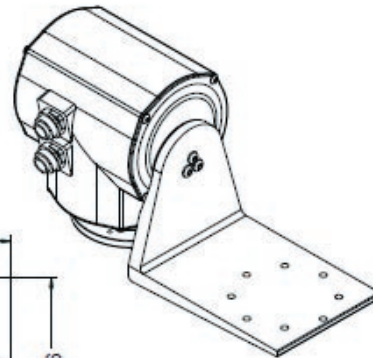

J-Systems, Inc.

1 South 678 School Ave., Lombard, IL 60148

T 630-627-3458 F 630-620-0960

Web Site: <http://J-Systems.com> E-Mail: info@J-Systems.com